

POSITION NUMBER	PART NAME
2	TOP HINGE MEC /2451
9	HINGE MIDDLE/473
16	ADJUSTABLE FOOT M8X35
18	ICE TRAY COMMON
18A	F SHELF TOP/373 RV1
18B	F SHELF BOTTOM/373
37	R GLASS SHELF/373
38	R.GLASS SHELF FRONT EXT/366
39	CRISPER GLASS SHELF/373
40	CRISPER FLAP GR/373
41	CRISPER GR
71	WINE SHELF 373 (OPTIONAL)
89A	HINGE COVER 2451
333	CRISPER ROLLER/540
339	CHILLER GR/373
641	BOTTOM HINGE GR/373
722	BOTTOM BASKET GR./373
725	TOP BASKET GR./373
726	CRISPER RAIL RIGHT/373
727	CRISPER RAIL LEFT/373
753	CHILLER RAIL LEFT/373
754	CHILLER RAIL RIGHT/373

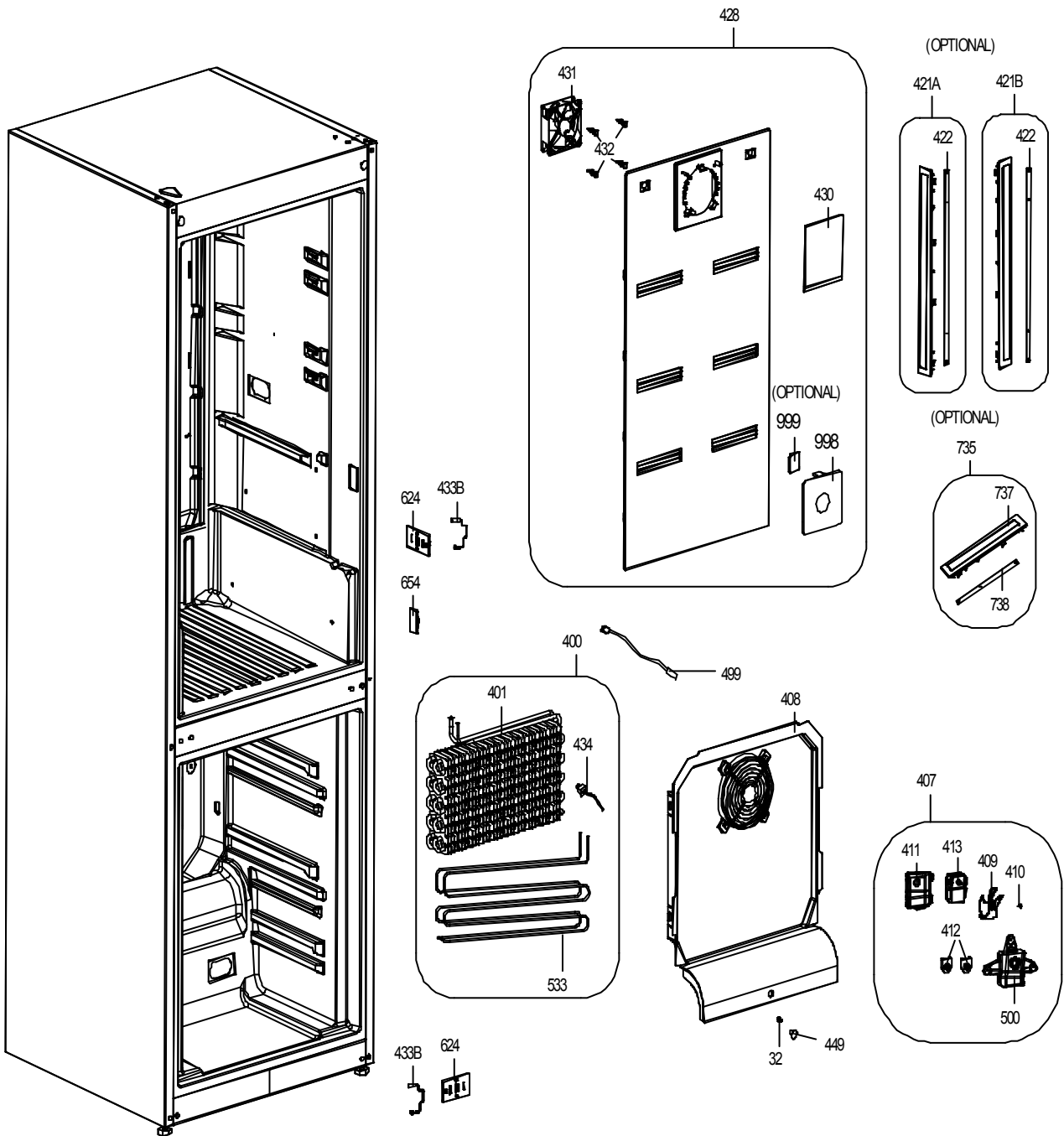

POSITION NUMBER	PART NAME
32	SCREW KA 40*18 YSB-C-INOX
400	FIN EVAP.ASSY/353-373
401	FIN EVAPORATOR/353-373
407	F FAN MOTOR GR/463
408	F MULTIFLOW GR/373
409	FAN PROPELLER120MM CCW /473
410	PROPELLER SPRING
411	F FAN MOTOR COVER/370
412	MOTOR ABSORBER/7W
413	FREEZER FAN MOTOR / AC 463
421A	LED COVER GR/373 RIGHT
421B	LED COVER GR/373 LEFT
422	LED STRIP/COOL.463/12*3014/12V
428	R MULTI FLOW ASSY/383
430	COOLING FAN COVER/473
431	TUR.FAN MOTOR
432	MOTOR FAN KAU.916-NEW
434	F SENSOR/540
449	R MULTIFLOW CAP/ 640
500	F FAN MOTOR BOX/370
533	FIN EVAP HEATER/373/230V/124W
624	SENSOR COVER 473
654	REED SWITCH GR/590UHS
735	LED COVER GR/319
737	LED COVER/319
738	LED STRIP/2835*6/8*129MM/12V/373
433B	SENSOR/STANDARD/R6K/70MM/SINGLE
998	ION BODY GR383 (<i>OPSIYONAL</i>)
999	IYONIZER/GR (<i>OPSIYONAL</i>)

VESTEL
WHITE GOODS

383 ELECTRONIC

DOOR ASSY. PARTS

**CUSTOMER
SUPPORT**

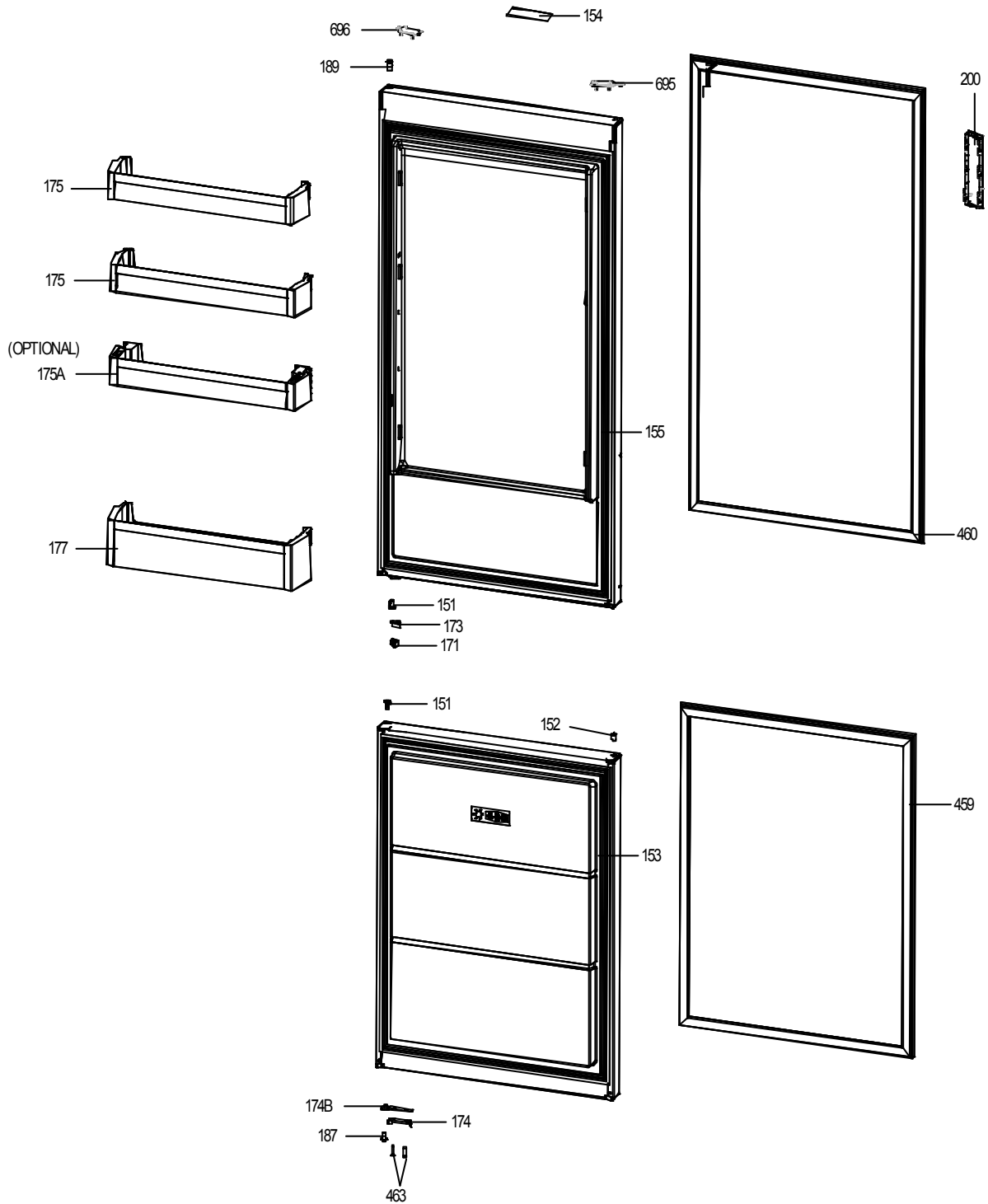

FEBRUARY 2017

VESTEL WHITE GOODS	383 ELECTRONIC	CUSTOMER SUPPORT
	DOOR ASSY. PARTS LIST	

POSITION NUMBER	PART NAME
151	BUSHING/345
152	BUSHING CAP
153	F DOOR ASSY/383-AGE
154	LOGO
155	R DOOR ASSY/383E-AGE-IMD
159	EGG HOLDER
171	STOPPER REINFORCEMENT PLS. 373
173	DOOR CATCHER STOPPER/473
174	R BOTTOM STOPPER/HC
174B	R BOTTOM STOPPER REINFORCEMENT 473
175A	ADJUSTABLE DOOR SHELF GR/373 (<i>OPTIONAL</i>)
175	CHEESE/BUT.SHELF/373
177	BOTTLE SHELF/373
200	DISP.PAN.GR/IMD
187	BUSHING/345CE
189	BUSHING/540CE
460	R DOOR GASKET/383
459	F DOOR GASKET/373
463	SCREW TT M5*20 YHB-F
695	R/D PANEL COVER 373 RIGHT
696	R/D PANEL COVER 373 LEFT

ABBREVIATIONS :

ASSY : ASSEMBLY
 R : REFRIGERATOR
 F : FREEZER

FEBRUARY 2017

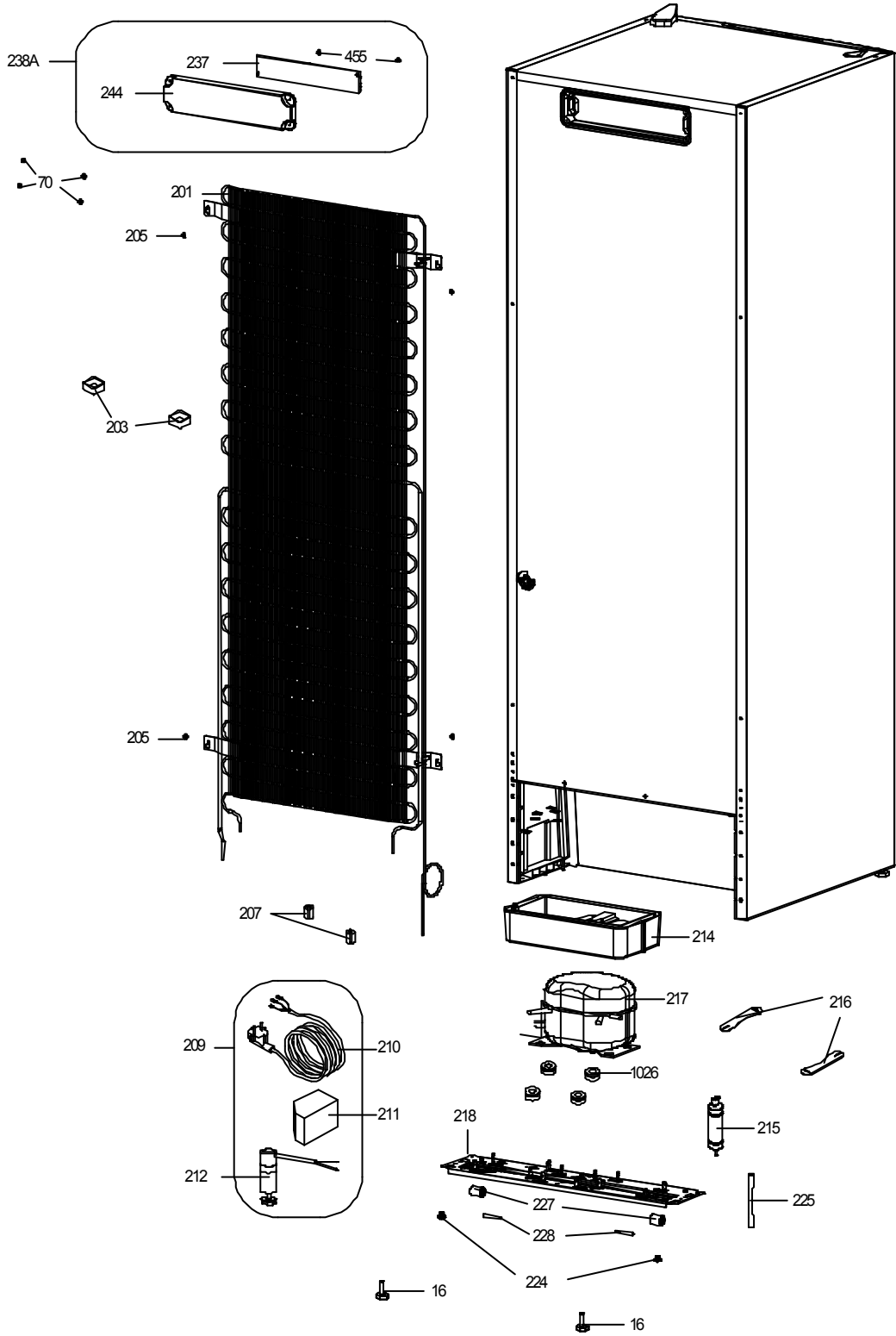

POSITION NUMBER	PART NAME
70	SCREW KA 40*14 YSB-R-F-INOX
201	MAIN CONDANSER
203	SPACER
205	SCREW ST 4.8*13 YSB-T-C
207	ANTIVIBRATION (CONDANSER)
209	POWER CORD GR
210	POWER CORD
211	OVER LOAD RELAY
212	CAPACITOR
214	EVAPORATING TRAY
215	DRYER
216	COMP FIXING BRACKET
217	COMPRESSOR
218	COMP BASEMENT/345
224	SCREW KA 50*14 YSB-F
225	SERVICE TUBE
237	MB/BDA02/353
244	MAINBOARD COVER 3663E/V0
455	SCREW KA 30*6 YSB-F
1026	COMPRESSOR RUBBER
238A	MAINBOARD COVER GR 353E